

Cars & Trucks with Upper & Lower Control Arm

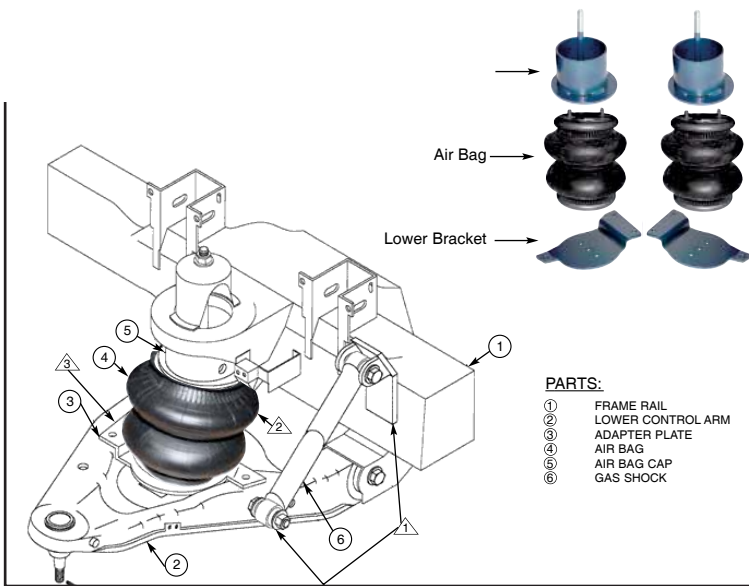

You will need to purchase a shock relocater kit. Brackets must be tack welded with the shock extended, and permanently welded after checking travel.

Remove, or modify bump stops as necessary. Do whatever it takes to ensure bag does not contact metal.

Temporarily tack-weld bottom plate to determine proper position on Lower Control Arm

Bolt top plate to airbag, rotate for position as necessary

Before permanently welding into position, make sure your shock travel and airbag has complete travel without touching other components. Abrasions or cuts from body contact are not covered by warranty.

MEASURE TWICE, cut and weld only once!

Most Mini Trucks

Any obstructions such as brake lines or shock towers must be removed to allow the new brackets to be installed. Weld reinforcement gussets as necessary to strengthen frames/supports.

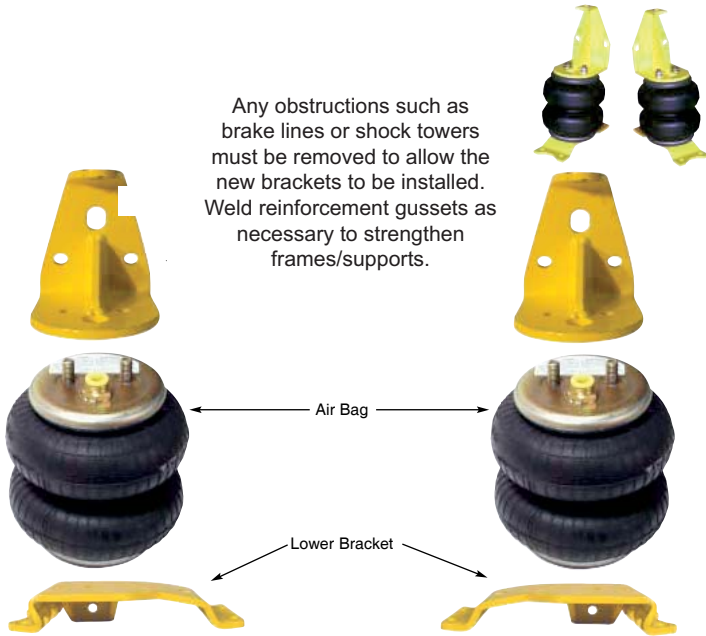

Remove or loosen torsion bars

You will need to purchase a shock relocater kit. Brackets must be tack welded with the shock extended, and permanently welded after checking travel.

Remove, or modify bump stops as necessary. Do whatever it takes to ensure bag does not contact metal.

Temporarily tack-weld bottom plate to determine proper position on Lower Control Arm

Bolt top plate to airbag, rotate for position as necessary

Before permanently welding into position, make sure your shock travel and airbag has complete travel without touching other components. Abrasions or cuts from body contact are not covered by warranty.

MEASURE TWICE, cut and weld only once!

Ford Trucks & Vans with I-Beams *WELDON KIT

This kit is for use with FACTORY BEAMS, if you have had lower I-Beams installed, you will have to use the optional lowered barrels.

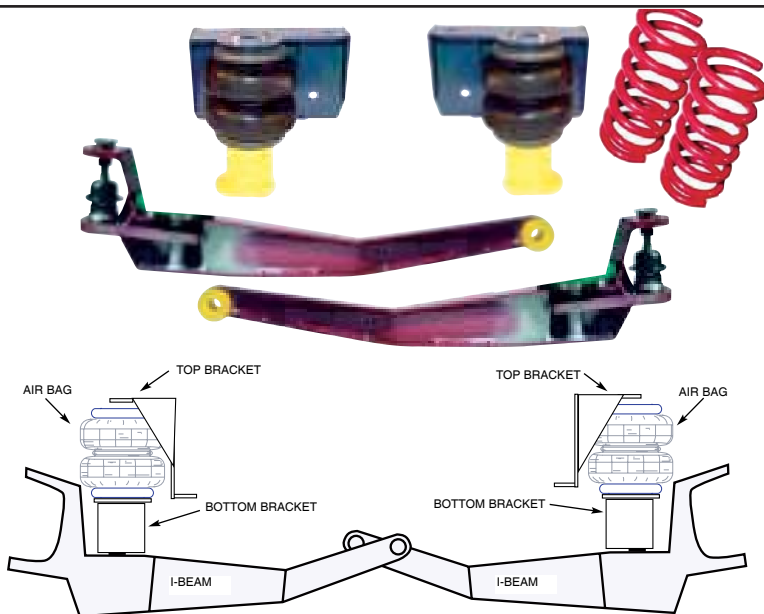

You will need to purchase a shock relocater kit. Brackets must be tack welded with the shock extended, and permanently welded after checking travel.

The drivers side is curved and must be cut with a diegrinder. Remove just enough to fit new brackets snugly in place. Tack-weld or bolt temporarily in place.

When you are **SURE** of position, have a certified welder apply finished welds.

Make sure bags/brackets are straight up/down in relation to upper brackets and perch bolt when at drive height. Do not use existing holes as a guide. Radius arms can be adjusted up to 1/2" if necessary. Abrasions or cuts from body contact are not covered by warranty.

MEASURE TWICE, cut and weld only once!