

Typical Flip Kit Installation Instructions

(Click on picture of part to purchase.)

WE RECOMMEND THAT YOU USE SHOCK EXTENDERS OR THAT YOU USE A SHORTER SHOCK WHEN INSTALLING A FLIP KIT, BOTH OF WHICH YOU CAN GET FROM US.

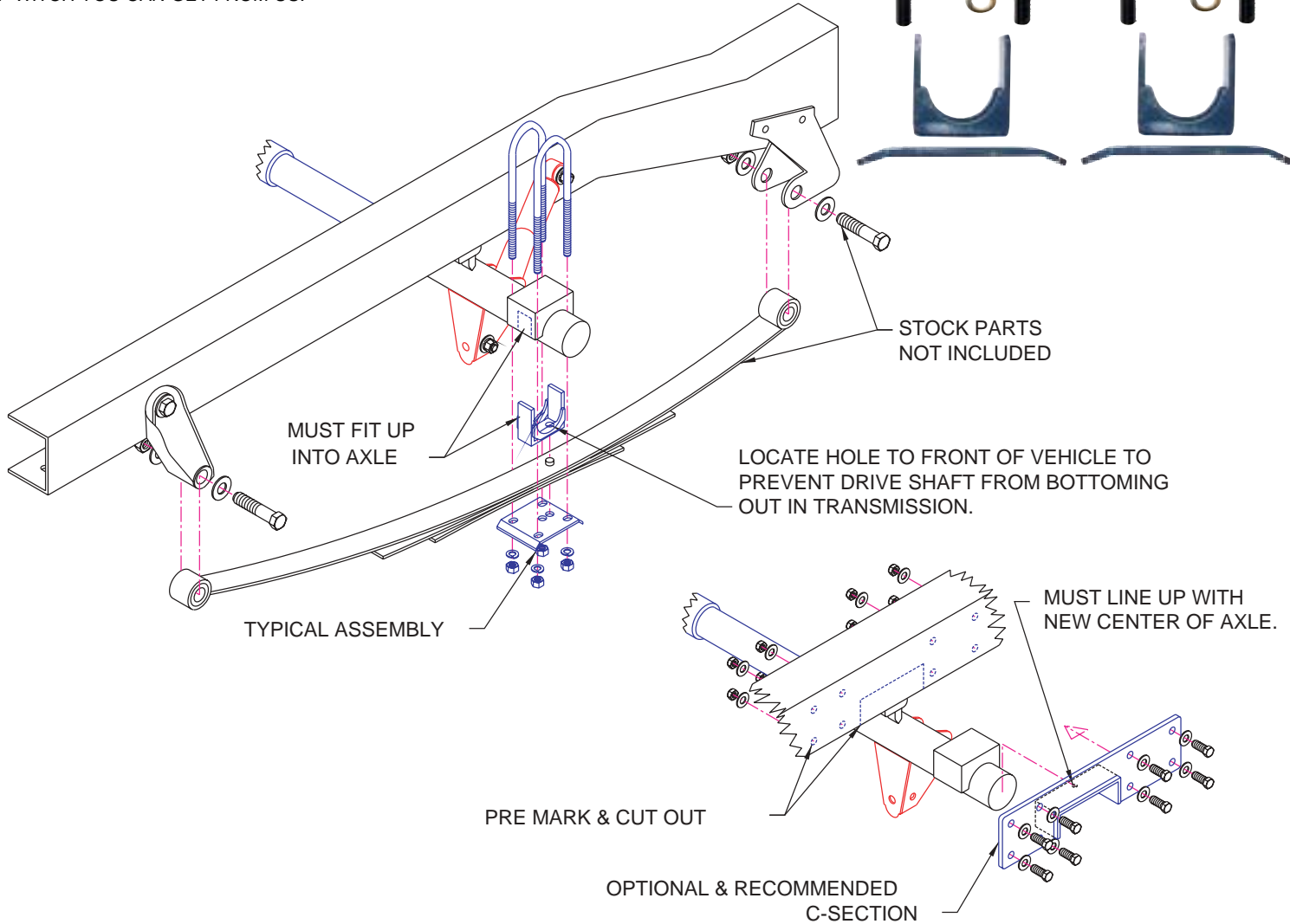
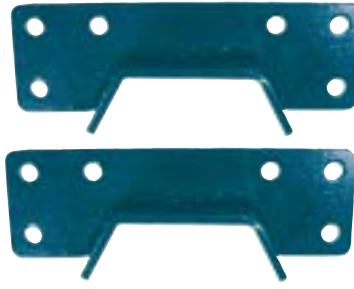

NOTE: KIT WILL LOWER A STOCK TRUCK 5-6". THE TRUCK BED MUST BE REMOVED TO INSTALL. STOCK LEAF SPRINGS WILL BE RELOCATED BELOW THE REAR AXLE. AN OPTIONAL C-SECTION MUST BE PURCHASED TO NOTCH AND REINFORCE THE FRAME RAILS ON GM 88 & UP AND ON FORD F-150 TRUCKS.

1. REMOVE TRUCK BED, MOUNTING BOLTS, GROUND STRAPS, GAS TANK FILLER DOOR, AND WIRING HARNESS AT REAR BUMPER.
2. REMOVE THE BRAKE LINE MOUNT FROM THE FRAME RAIL ABOVE THE AXLE. REROUTE BRAKE LINES AND WIRING HARNESS AWAY FROM THE FRAME RAILS.
3. RAISE THE REAR END WITH A JACK TO RELIEVE TENSION ON SHOCKS. REMOVE SHOCKS FROM LOWER MOUNTS. LOWER JACK TO RELIEVE PRESSURE ON SPRINGS.
4. REMOVE FRONT AND REAR SPRING BOLTS AND U-BOLTS, TO FREE SPRING.
5. RAISE THE REAR AXLE AND REINSTALL LEAF SPRING UNDER THE AXLE. PLACE NEW AXLE RELOCATION BRACKET ON THE TOP OF THE LEAF SPRING WITH THE OFFSET HOLE TOWARD THE FRONT OF THE VEHICLE. MAKE SURE LEAF SPRING BOLT IS CENTERED IN BRACKET OFFSET HOLE.
6. LOWER AXLE DOWN INTO THE RELOCATION BRACKET. BE SURE THAT THE EARS ON THE RELOCATION BRACKET FIT UP INSIDE THE SADDLE WELDED TO THE AXLE.
7. PLACE U-BOLTS OVER THE AXLE, INSTALL THE SPRING PLATE ON THE BOTTOM OF THE LEAF SPRINGS. CROSS TORQUE U-BOLTS TO 80 FT.LBS. INSTALL SHOCK EXTENDERS OR NEW SHORTER SHOCKS.
8. YOU MUST TORQUE ALL BOLTS AFTER 100,500, AND 1000 MILES.